

Push chain 0605

Typ 60 PDG

4.5.4 Assembly of the standard chain link 5-0605-100.00

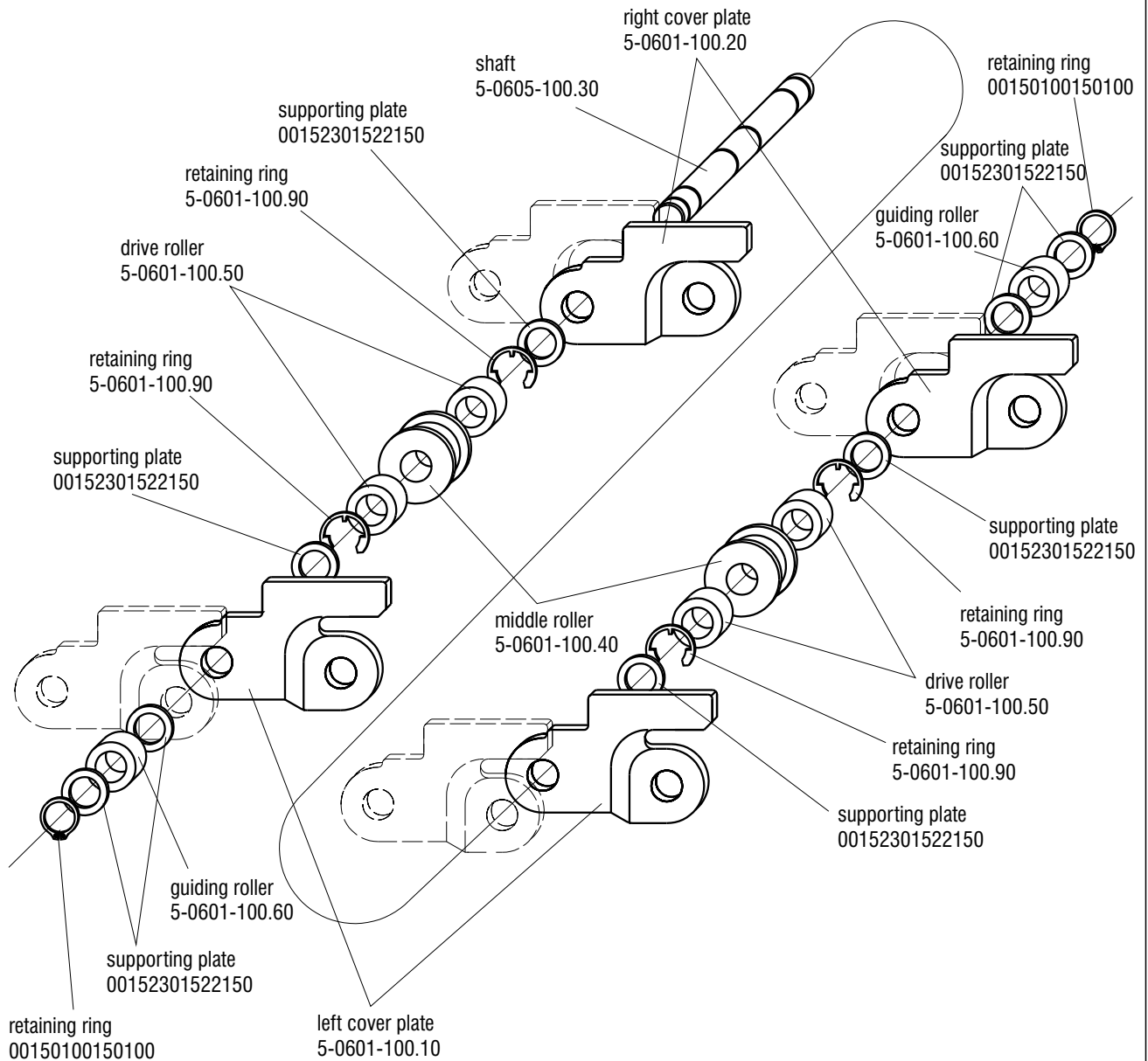

Subject to technical changes

Framo - Morat KG (GmbH & Co.)
Framo -Antriebstechnik

Po.-box 10 • D-79869 Eisenbach / Hochschwarzwald
Höchst 7 • D-79871 Eisenbach / Hochschwarzwald
Homepage: <http://www.framo-morat.com>

Tel. (07657) 88-0 • Fax (07657) 88-333

E-Mail: info@framo-morat.com